







28 450 410



- Brauseabgang 1/2"
- Rosette Ø 55 mm
- Anschluss 1/2"

Eigensicher gegen Rückfließen.

Passt zu MADISON

	Chrom	28 450 410-00
	Platin gebürstet	28 450 410-06
	Platin	28 450 410-08
	Messing (23kt Gold)	28 450 410-09
	Messing gebürstet (23kt Gold)	28 450 410-28
	Dark Platinum gebürstet	28 450 410-99

**Empfohlenes Zubehör**



**UP-Wandwinkel -**

35 085 970 90

- Max. Einbautiefe 163 mm
- Min. Einbautiefe 90 mm

28 450 410

mm [inches]

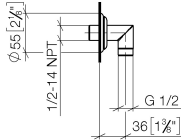

### Durchflussdiagramm



### Codes & Standards

EN 1717

Scottish Water  
Byelaws

UK Water Supply  
Regulations



## MADISON Wandanschlussbogen - Chrom

MADISON

28 450 410

Zertifikate

WRAS\_1809

Belgaqua\_21-381-2

28 450 410

**Produktversion bis 7/6/2018**

**Produktversion ab 7/6/2018**

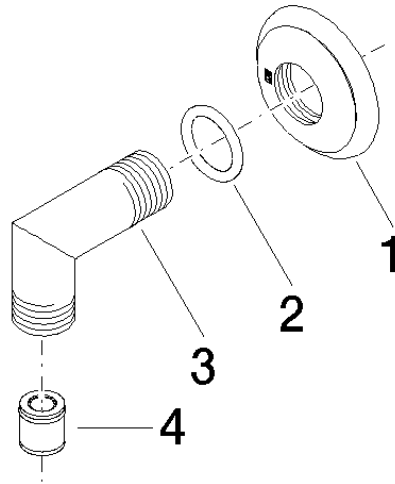



28 450 410

**Ersatzteilstückliste**

**Produktversion bis 7/6/2018**

**Produktversion ab 7/6/2018**

Nr.	Artikelnummer	Benennung	Verbaumenge	Lieferzeit
	09 27 35 003-00	Rosette Ø 55 x Ø 27 x 10 mm - Chrom	4	10