











30 010 892



- Ausladung 140 mm
- starrer Auslauf
- runder luftangereicherter Strahl
- Adapter mit AG 3/4"
- Bohrungsdurchmesser 32 mm
- Rosette Ø 55 mm
- Durchfluss max. 5,7 l/min
- bleifrei
- Dieses Produkt leistet einen Beitrag zur Erfüllung der Vorgaben von nachhaltigen Gebäudezertifizierungen, z.B. LEED®, BREEAM®, DGNB

	Dark Platinum gebürstet	30 010 892-99
	Chrom	30 010 892-00
	Platin gebürstet	30 010 892-06
	Platin	30 010 892-08
	Dark Chrome	30 010 892-19
	Light Gold gebürstet	30 010 892-27
	Messing gebürstet (23kt Gold)	30 010 892-28
	Schwarz matt	30 010 892-33
	Bronze gebürstet	30 010 892-42
	Champagne gebürstet (22kt Gold)	30 010 892-46
	Champagne (22kt Gold)	30 010 892-47
	Chrom gebürstet	30 010 892-93

30 010 892

mm [inches]

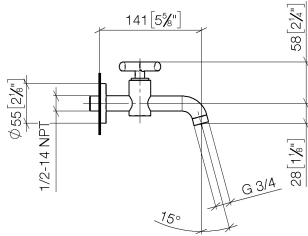

**Durchflussdiagramm**

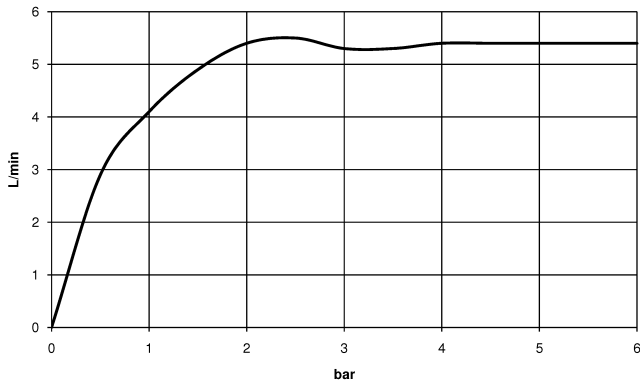

**Codes & Standards**

DIN 4109

ISO 3822

Ü-Zeichen



TARA Wandventil Kaltwasser ohne Ablaufgarnitur - Dark Platinum gebürstet

---

TARA

30 010 892

Zertifikate

---

LGA\_18

30 010 892

**Produktversion ab 6/30/2009**

Ersatzteile für die  
anderen  
Oberflächenvarianten  
finden Sie hier:  
Chrom

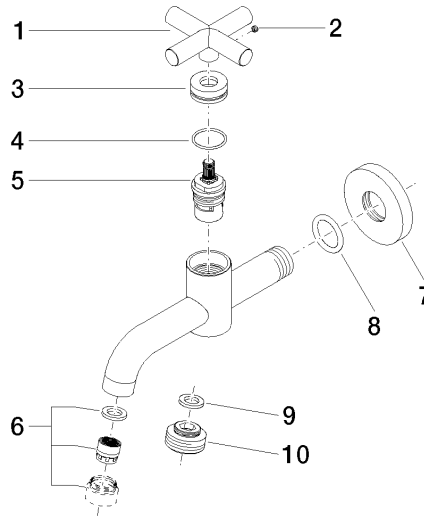



30 010 892

## **Ersatzteilstückliste**

**Produktversion ab 6/30/2009**